

BLESSING AND A CURSE

Designing Buildings to a Target EUI

Joseph F. Clair, P.E.

Practice Lead in High Performance Building Design

March 8, 2017

ENGINEER PUSHING FOR ENERGY EFFICIENCY...



INCLUDING TARGET EUI IN CONTRACTS...

Drives innovation and conversation

INCLUDING TARGET EUI IN CONTRACTS...

Drives innovation and conversation

Challenges – and adds risk to – the process

INCLUDING TARGET EUI IN CONTRACTS...

Drives innovation and conversation

Challenges – and adds risk to – the process

Shows integration of energy decisions

INCLUDING TARGET EUI IN CONTRACTS...

Creates conflict

Does not work well with the “way we usually do things”

Highlights that most people do not care about energy

ADDED CONFLICT

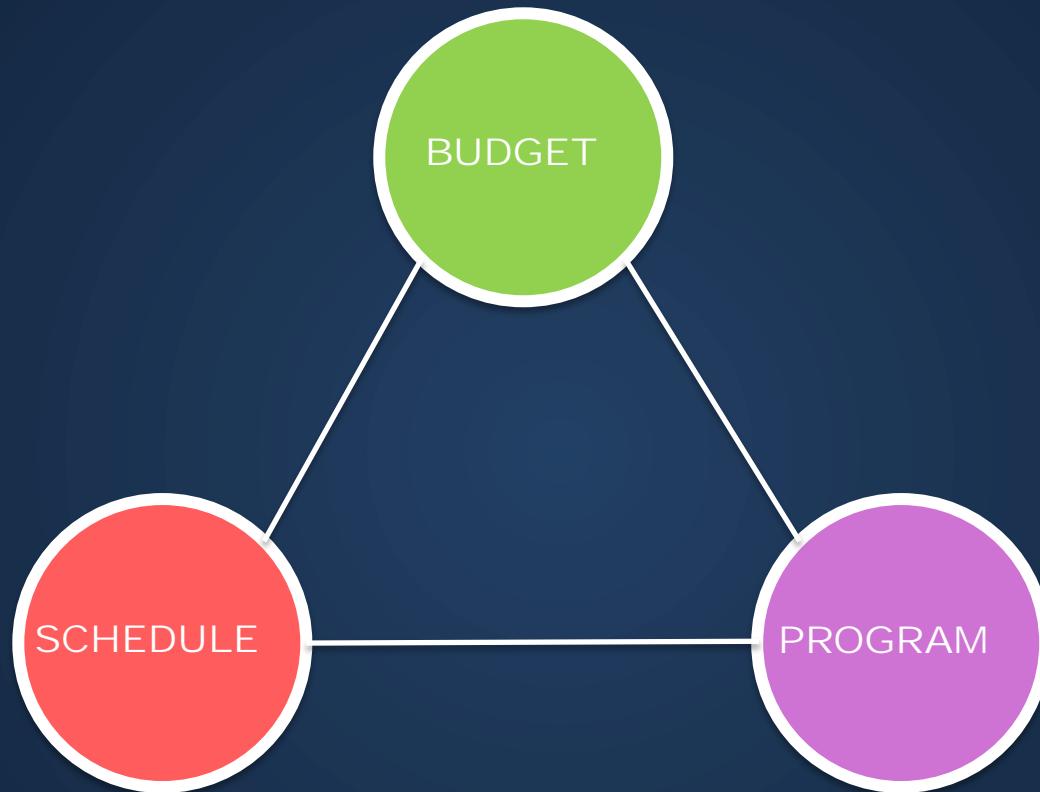

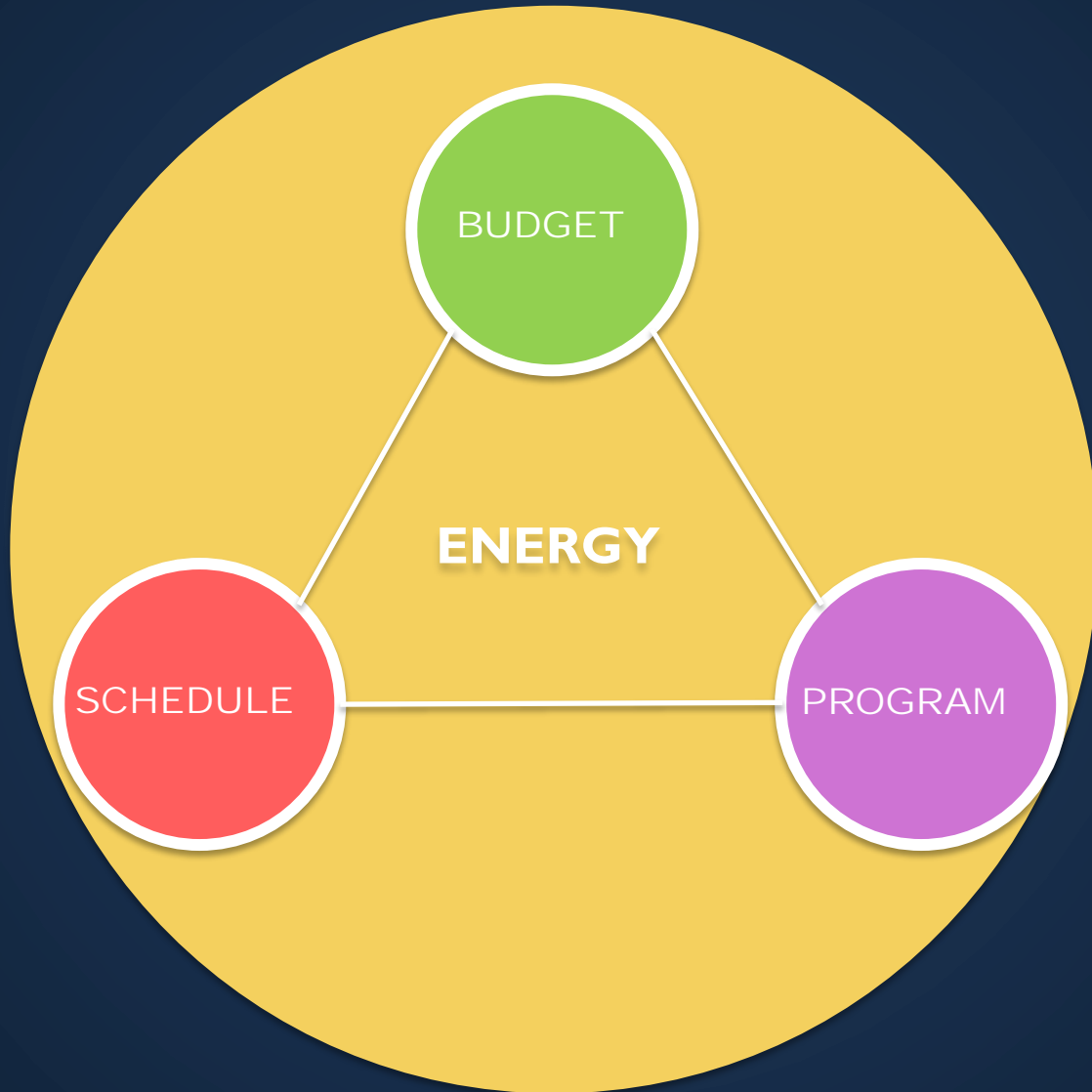

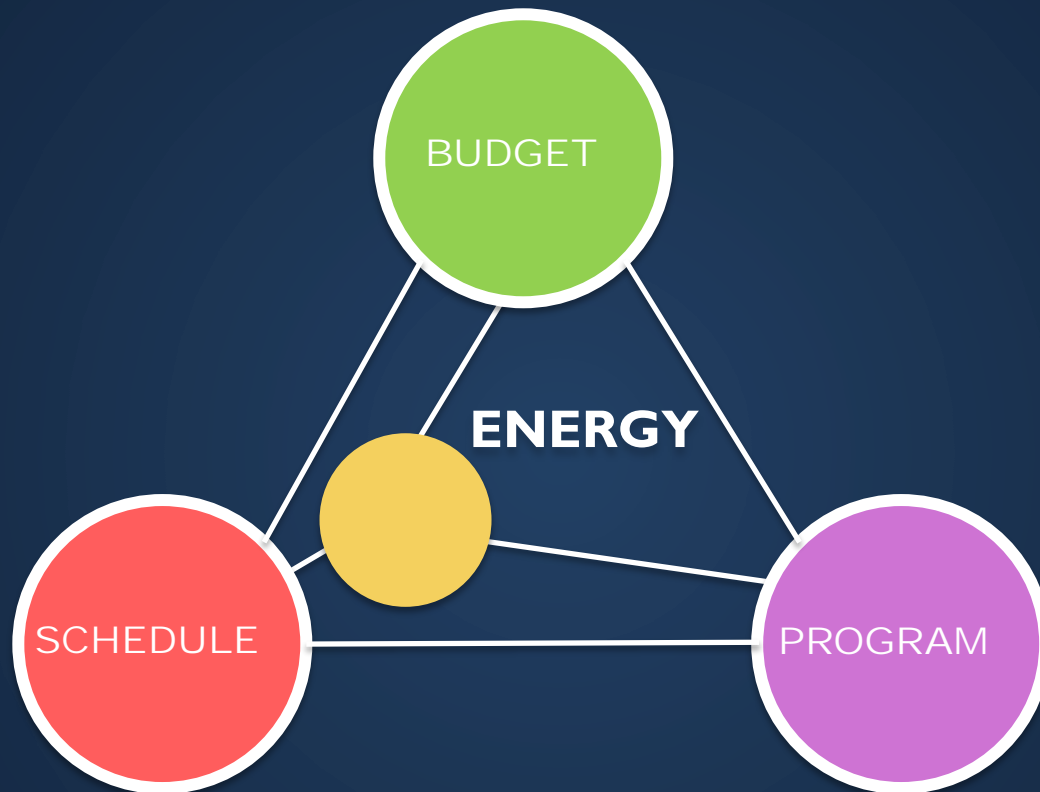

COST OF
CHANGE

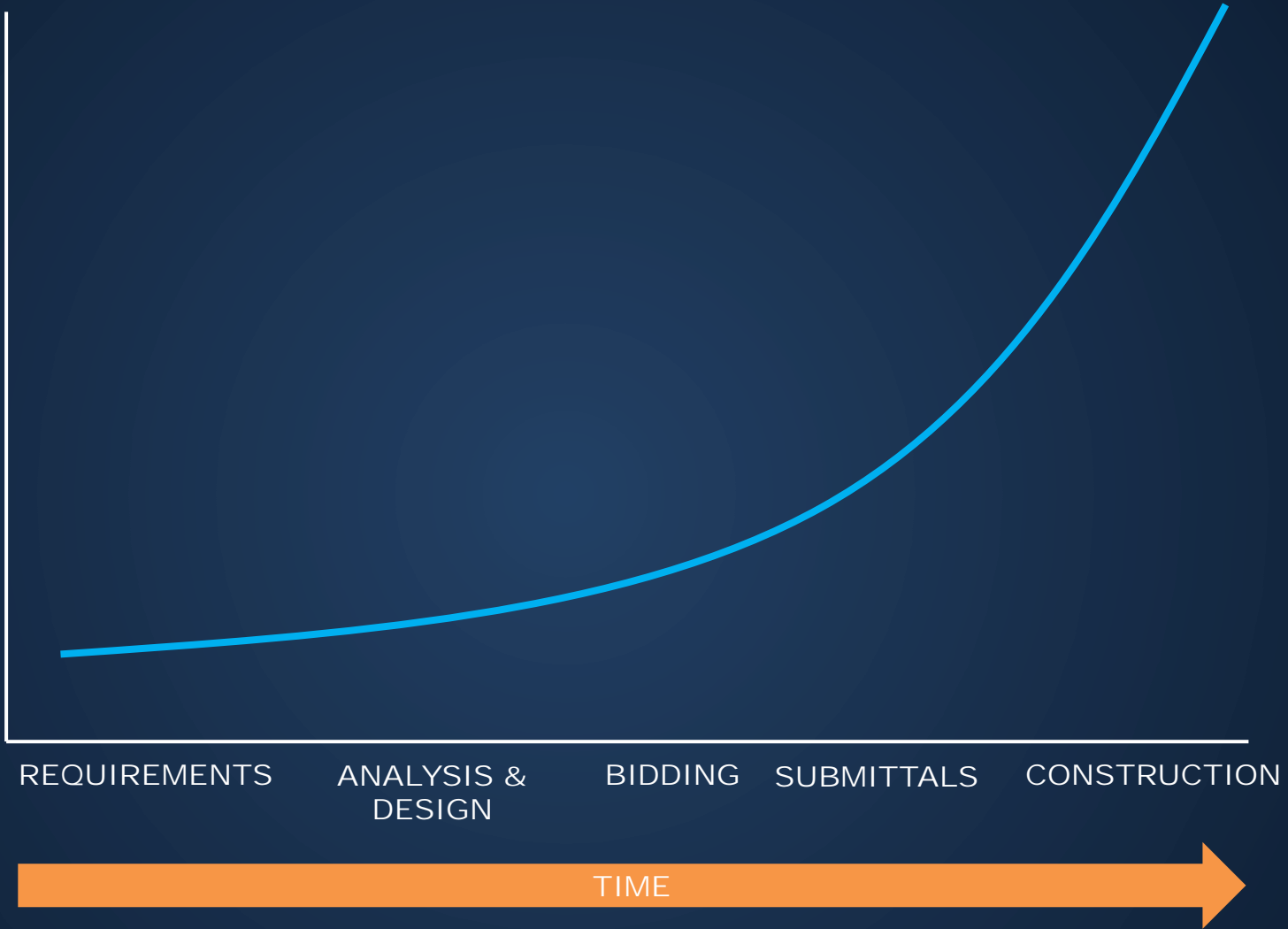

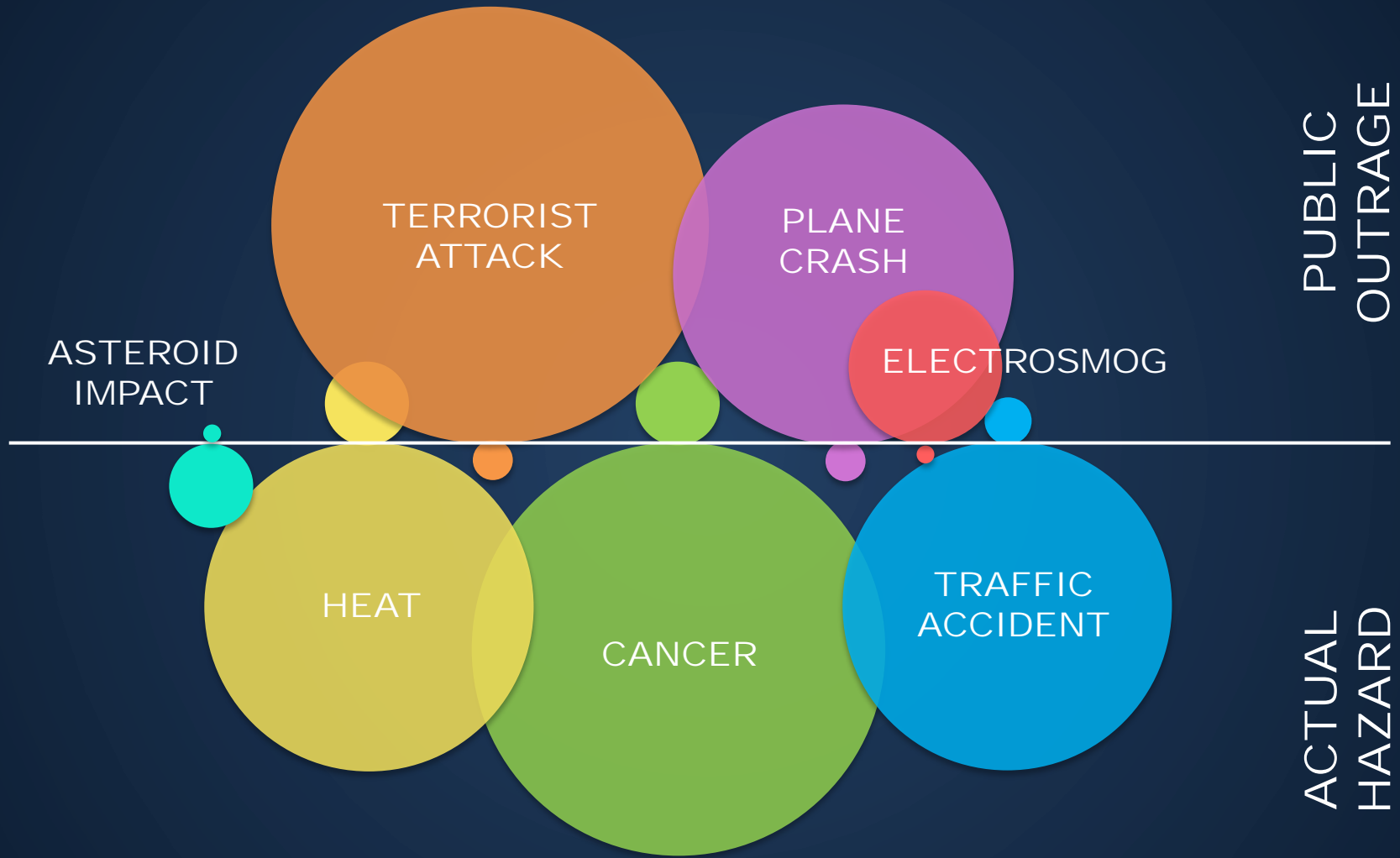

PUBLIC DREAD AND ACTUAL DEATHS IN RELATION TO WORLD ENERGY PRODUCTION

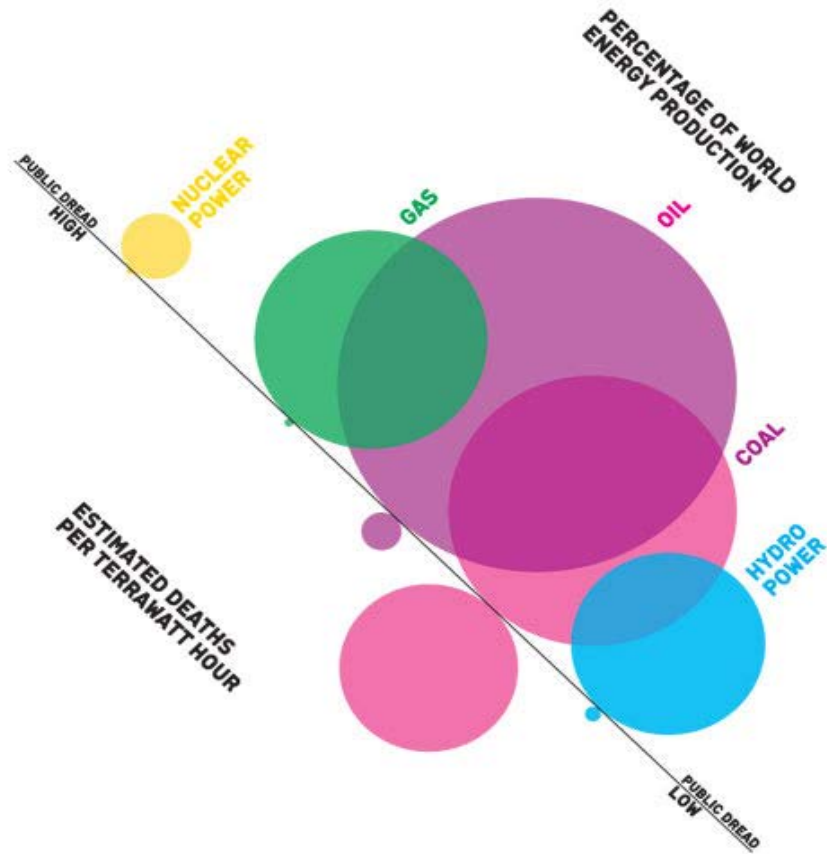

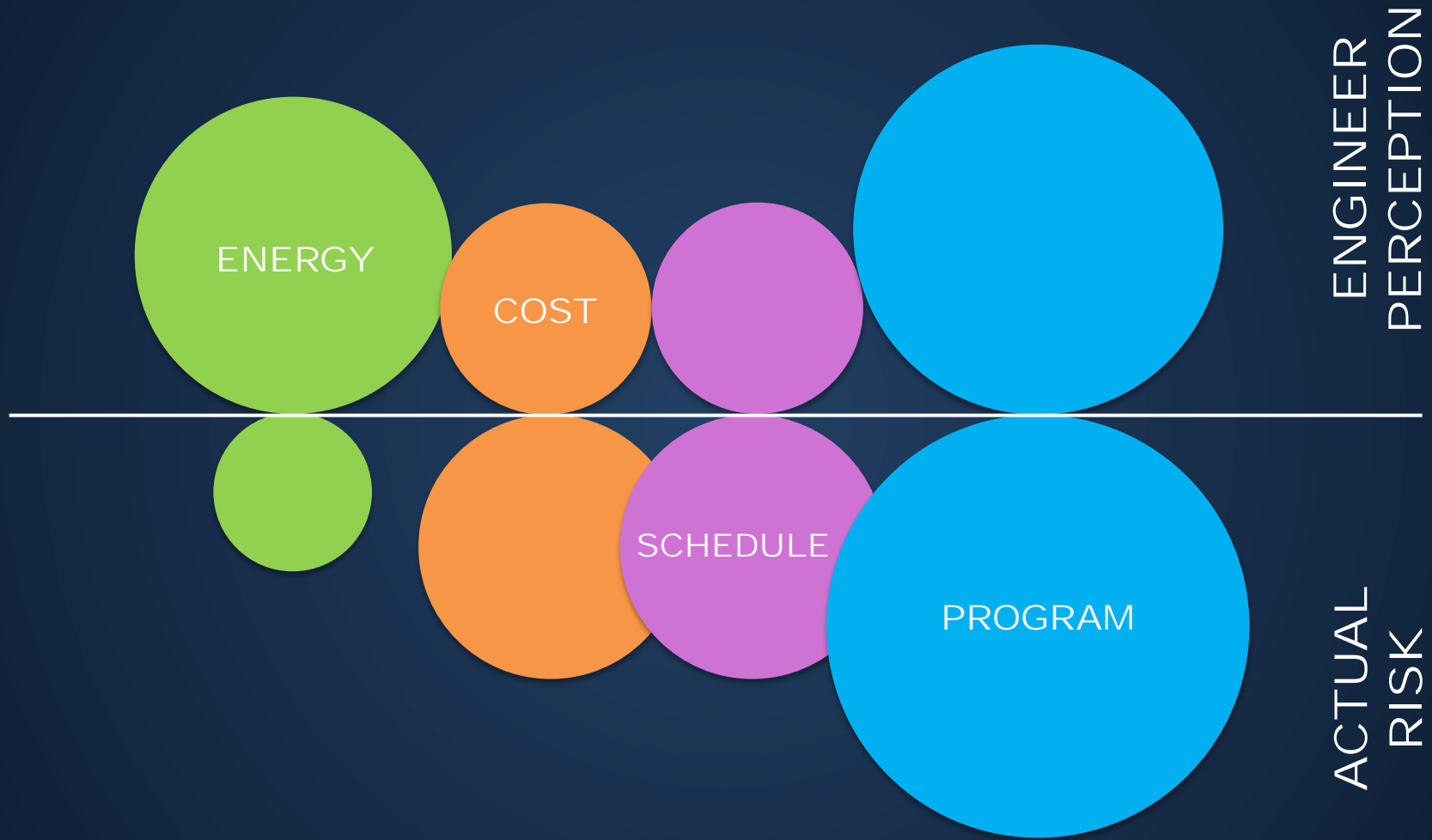

WAY WE DO THINGS

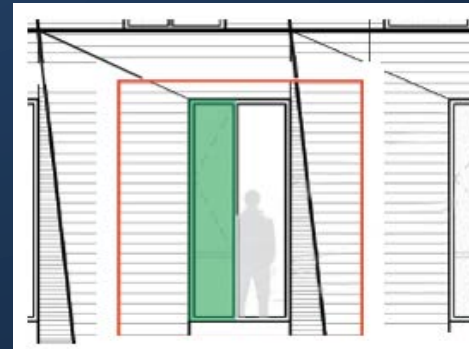
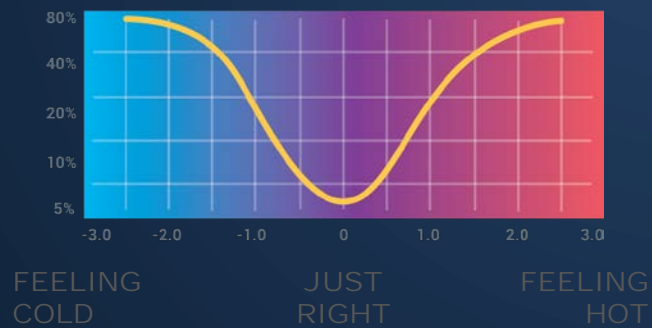

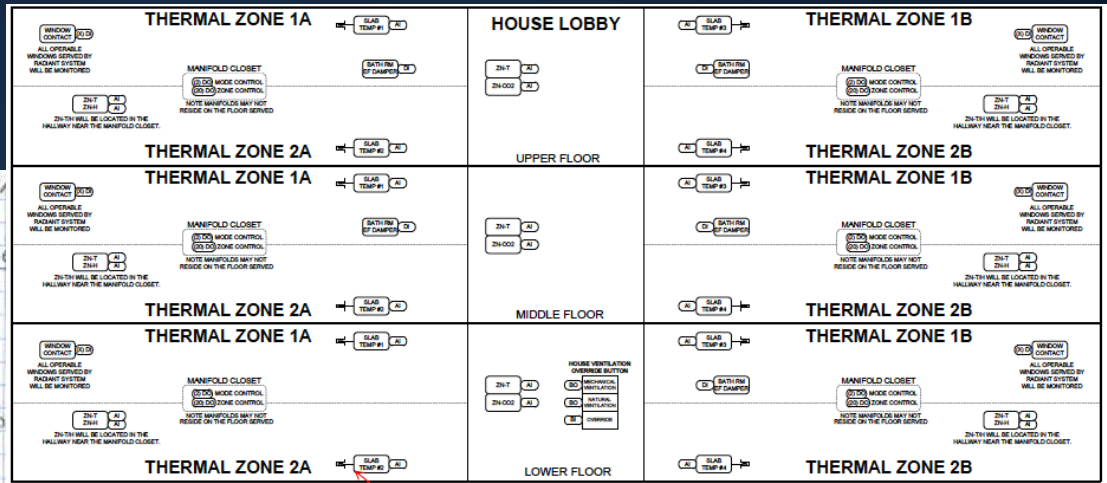
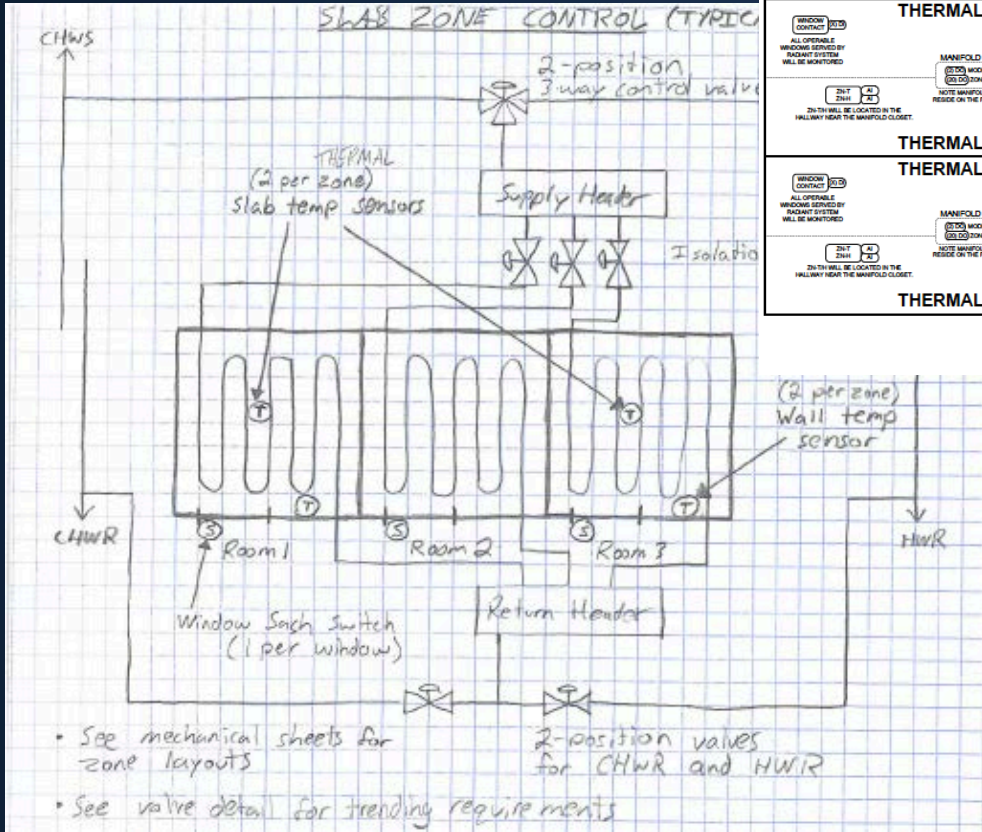

TWO SLAB SENSORS PROVIDED PER ZONE

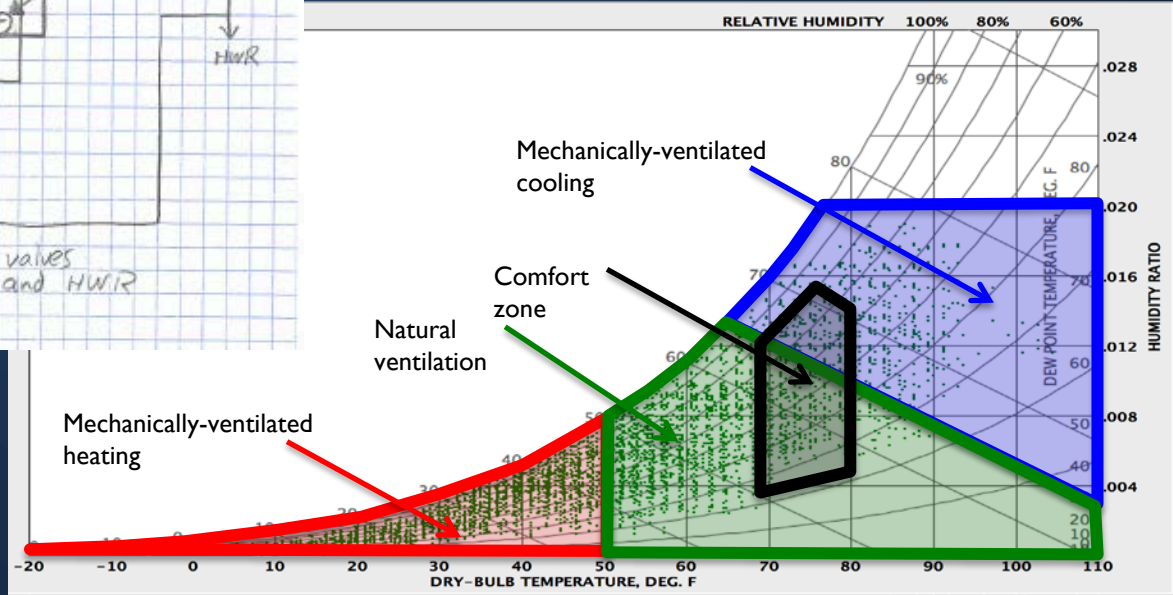



Building Systems Commissioning



Building Systems Commissioning



Building Envelope Commissioning

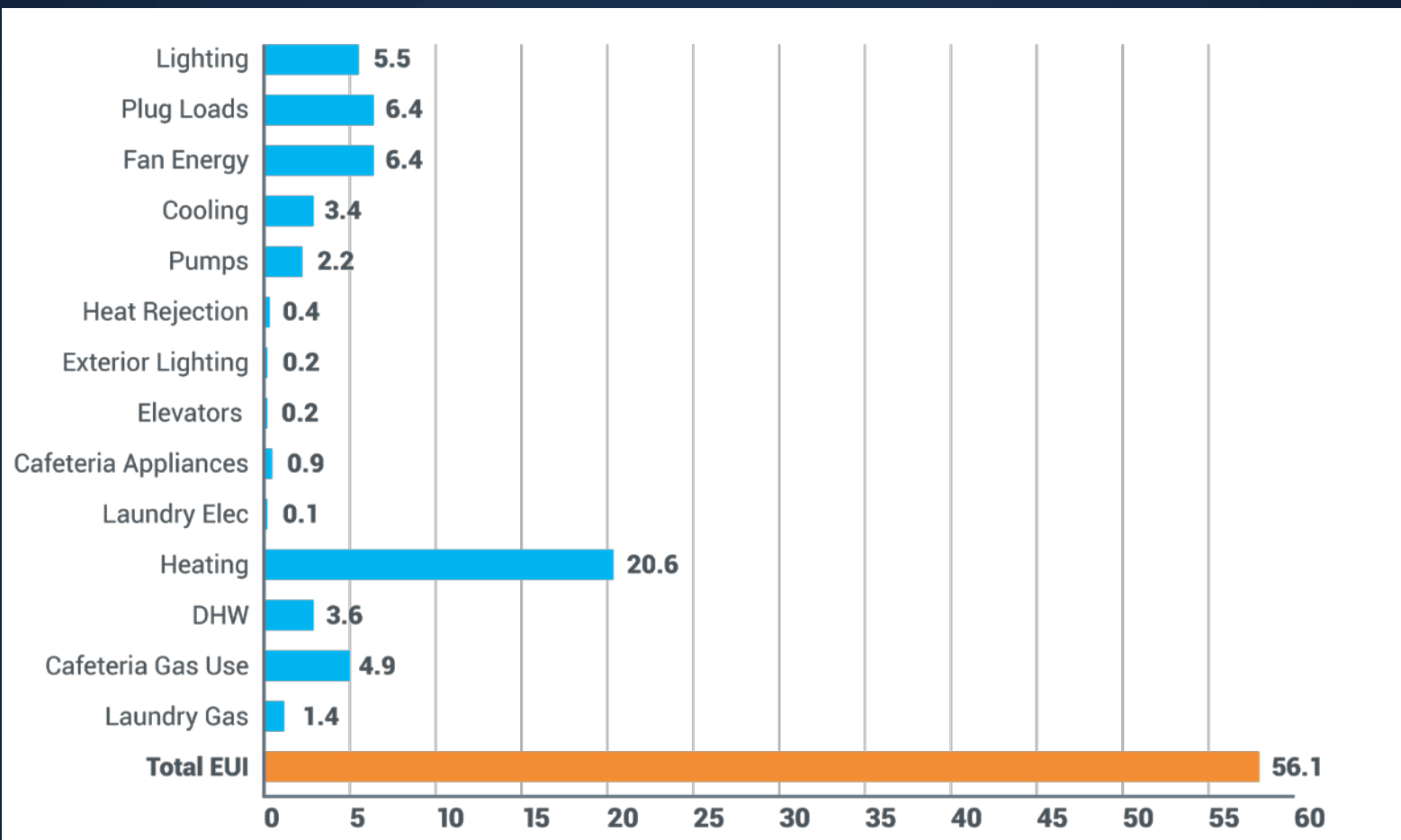

ENERGY KNOWLEDGE

SETTING EUI
TARGET

PLANNING FOR
EUI TARGET

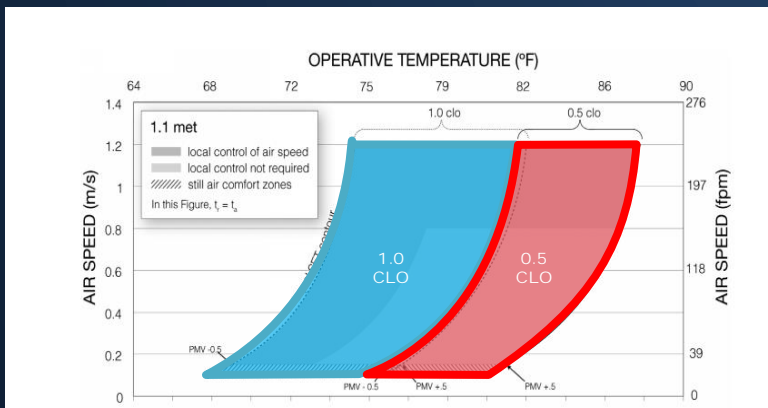
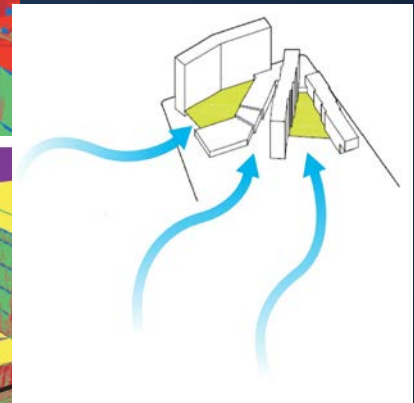
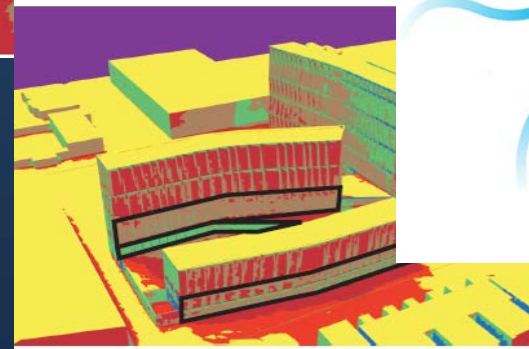
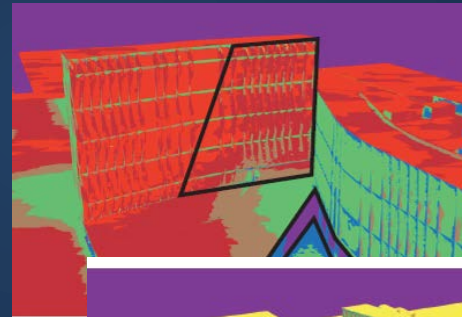
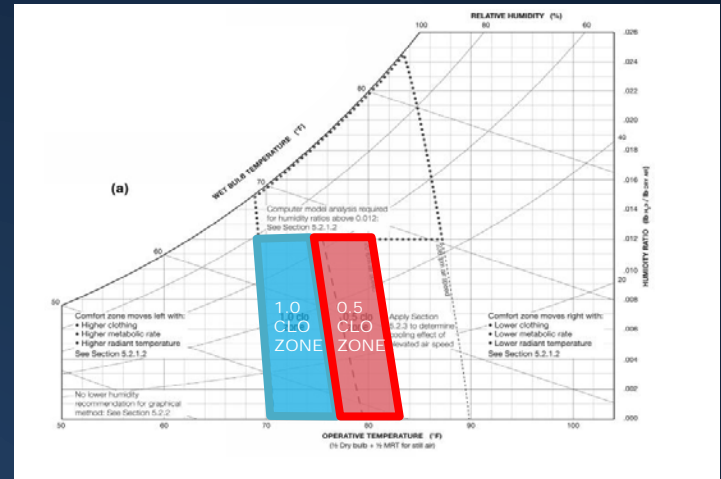
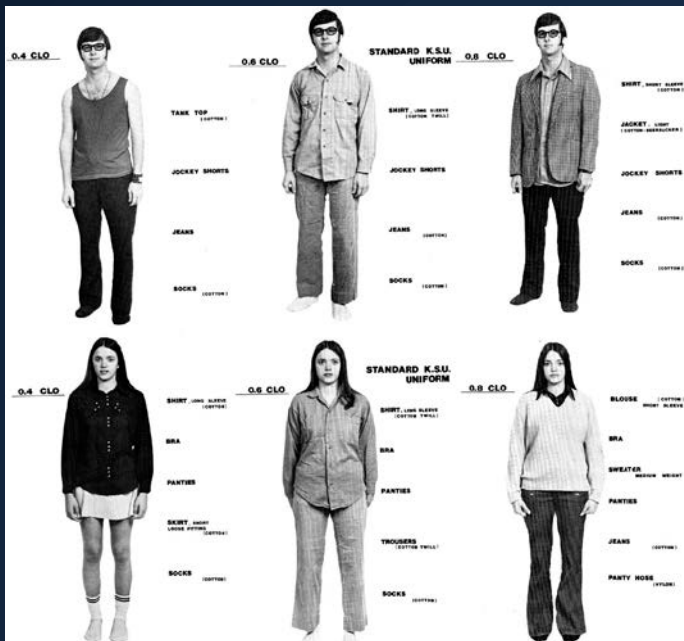

SO, HOW DOES IT WORK?

Whether or not a space is "comfortable" depends on more than just **air temperature** - even though that's the only thing that typical heating and cooling systems can affect. The **surface temperatures** of walls, ceilings, windows and floors also has a big impact on perceived "comfort" - even at the same air temperature!

This is the reason that you might feel more comfortable sitting **away** from a large window inside a café on a cold winter night, **under** the shade of an umbrella on a hot and sunny summer afternoon at the beach, or **beneath** the heating lamps while waiting for the train on an L platform on a chilly and windy autumn evening. In all of these cases, the air temperature is identical regardless of where you sit... but you can increase your comfort by changing your proximity to hot and cold surfaces!

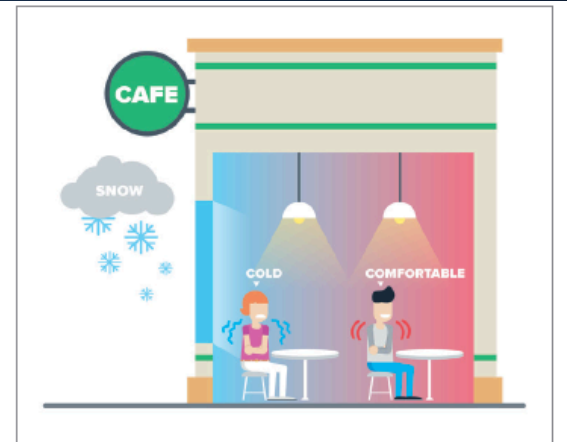

AWAY

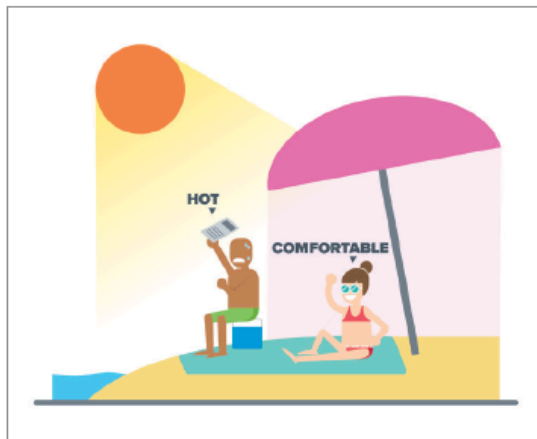

UNDER

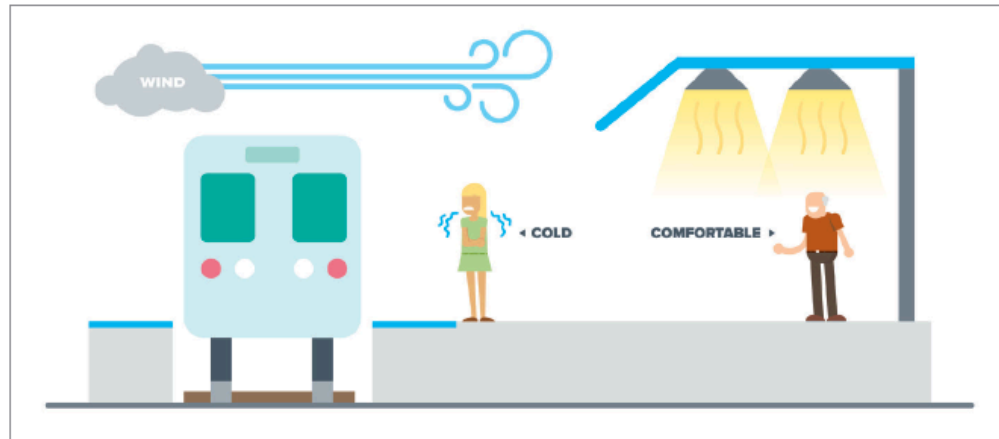

BENEATH

INCLUDING TARGET EUI IN CONTRACTS...

Creates conflict

Does not work well with the “way we usually do things”

Highlights that most people do not care about energy

DESIGNING WITH TARGET EUI...

Drive the conversation early...do not wait!

Analyze the process changes early and get buy in.

Educate everyone and perform sensitivity early.

DESIGNING WITH TARGET EUI...

Drive the conversation **early**...do not wait!

Analyze the process changes **early** and get buy in.

Educate everyone and perform sensitivity **early**.